

CASUALTY CARD & PACKAGE INSERT INCLUDED IN PACKAGING

INSTRUCTIONS FOR USE:

1) Open the package and remove applicator.

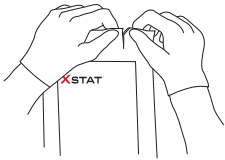

2) Pull the black handle out and away from barrel until it stops and locks.

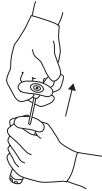

3) Place the tip of the applicator into the wound track as close to the bleeding source as possible.



4) Firmly depress black handle to deploy sponges into the wound. Material should flow freely into the wound. Deploy XSTAT within 30 seconds of insertion into wound.

DO NOT attempt to forcefully eject the material from the applicator. If resistance is met, pull back slightly on the applicator body to create additional packing space, then continue to depress handle.

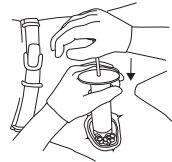

5) Use additional applicators as necessary to completely pack the wound with sponges.

DO NOT attempt to remove sponges from wound. Sponges must be removed intraoperatively by surgeon with the capability and equipment for achieving proximal and distal vascular control.

6) Cover the wound with an occlusive or pressure dressing. If available, use an elastic bandage.

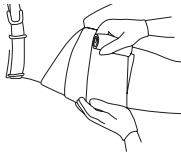

7) If bleeding persists, apply manual pressure until bleeding is controlled.



8) Remove the included casualty card from the pouch located underneath this label. Assess patient for peripheral circulation and document presence of distal pulse on included casualty card.

WARNING: Vascular compression greater than four hours is not recommended due to concerns related to limb ischemia.

9) Document clinical assessments, treatments rendered, and changes in the casualty's status on the included casualty card. Forward this information with the casualty to the next level of care.

WARNING:

Triangular segments of the applicator tip may break away from applicator during treatment. If this occurs, do not attempt to retrieve it from the wound. Record number of separated applicator tips on casualty card.

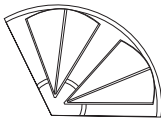

REVMED X™

RevMedx, Inc.
25999 SW Canyon Creek Road
Suite C
Wilsonville, OR 97070
PH: 503.218.2172
www.RevMedx.com
Label ID: RAW-0006-12
Label Issuance Date: 2017-05-15

Go to www.revmedx.com for training video and product information.